

**PLAN**  
SCALE 1"=40'

SHEET No 4  
PART No 1  
PLAN No 900  
FOR THE IMPROVEMENT OF  
**39<sup>TH</sup> STREET**  
BETWEEN  
SIERRA WAY AND MOUNTAIN VIEW AVENUE

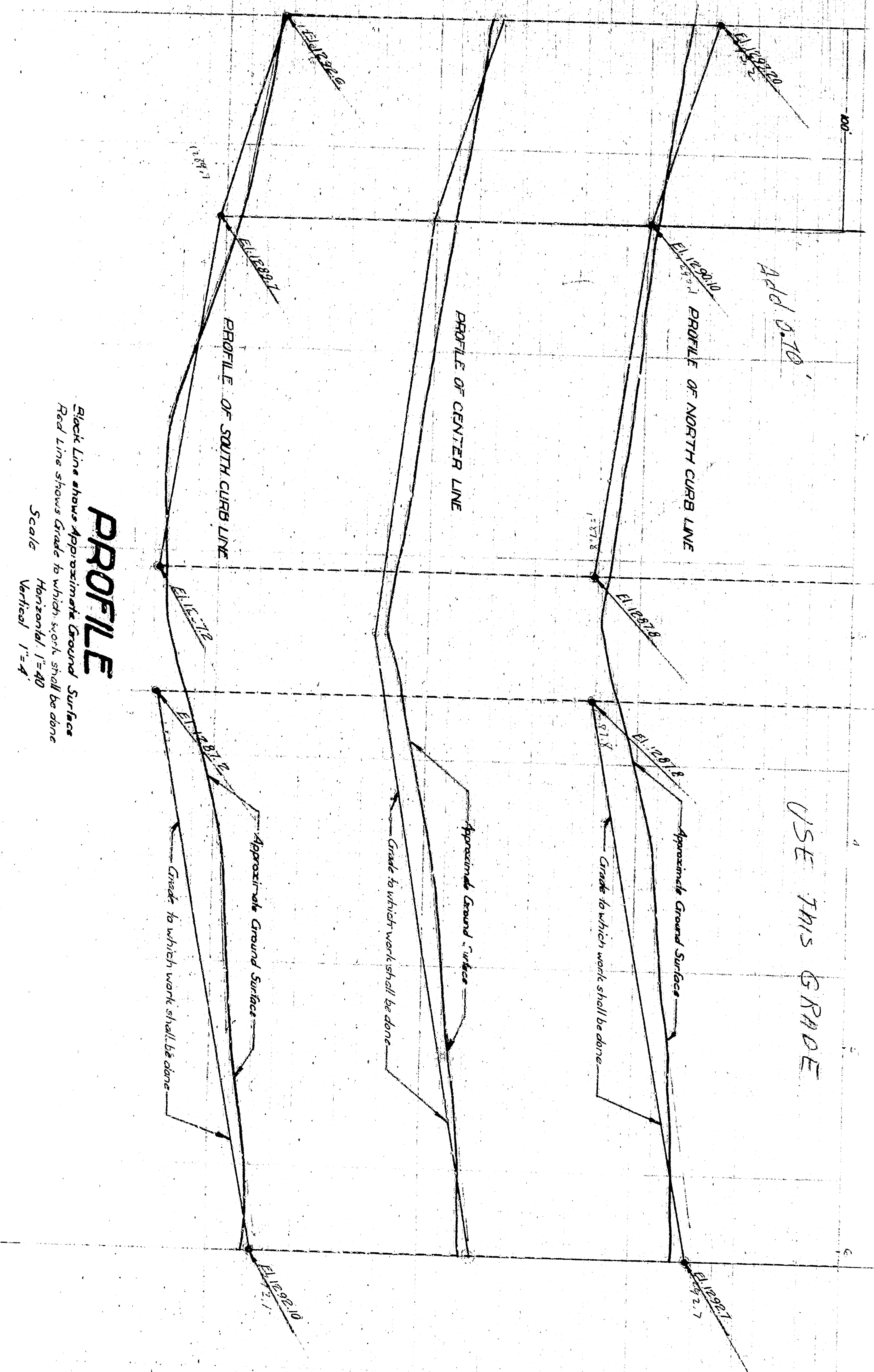

**PROFILE**  
Scale  
Horizontal 1"=40'  
Vertical 1"=4'

USE THIS GRADE

**NOTE:** Legend on Sheet No. 1, Genevieve Street  
Curb Station on Sheet No. 1  
Plan Station on Sheet No. 3  
Stationing on Sheet No. 3  
Sections of Bureau of Highway 44 and B.B. No. 1  
Sections of Bureau of Highway 44 and B.B. No. 3

**TITLE TO STREET**  
Title of 39<sup>TH</sup> STREET by City of San Bernardino is by Dedication of the  
Sierra Way Tract as recorded in Book 39 of Maps Page 65 Records of  
San Bernardino County California.

**GRADE ORDINANCE**  
Grade of 39<sup>TH</sup> Street established January 25<sup>TH</sup> 1956 Ordinance No. 1283



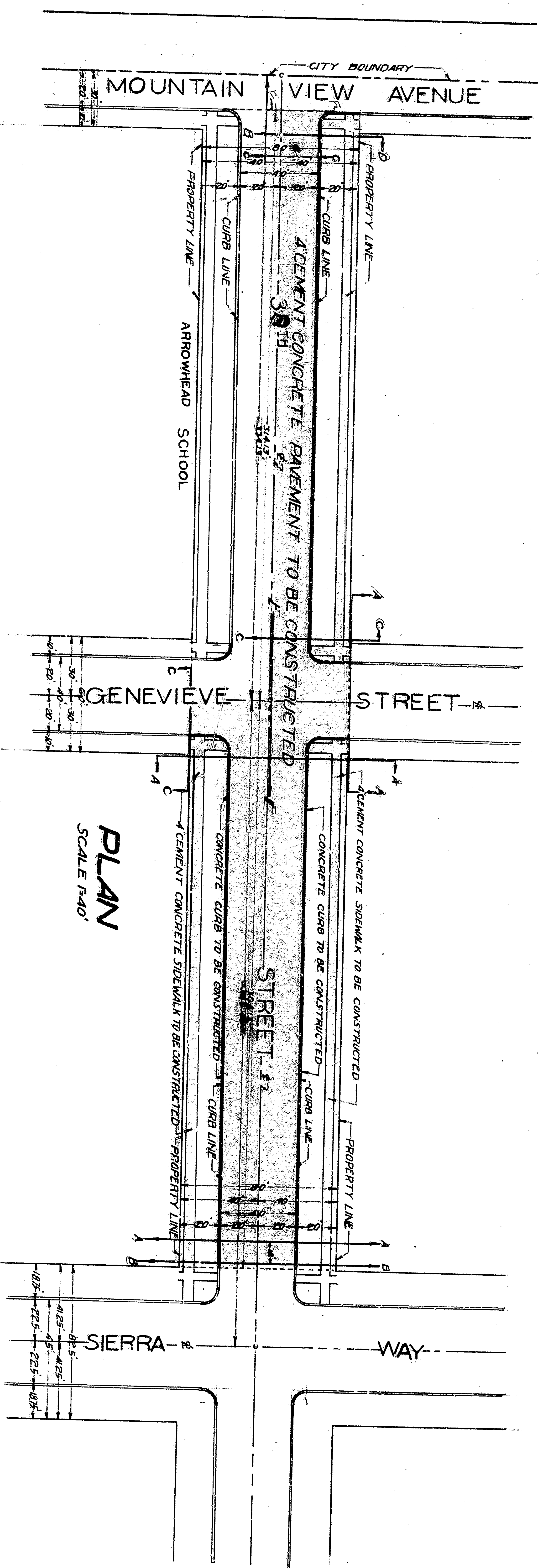

**PLAN**  
SCALE 1"=40'

SHEET No 4  
PART No 1  
PLAN No 900  
FOR THE IMPROVEMENT OF  
**39<sup>TH</sup> STREET**  
BETWEEN  
SIERRA WAY AND MOUNTAIN VIEW AVENUE

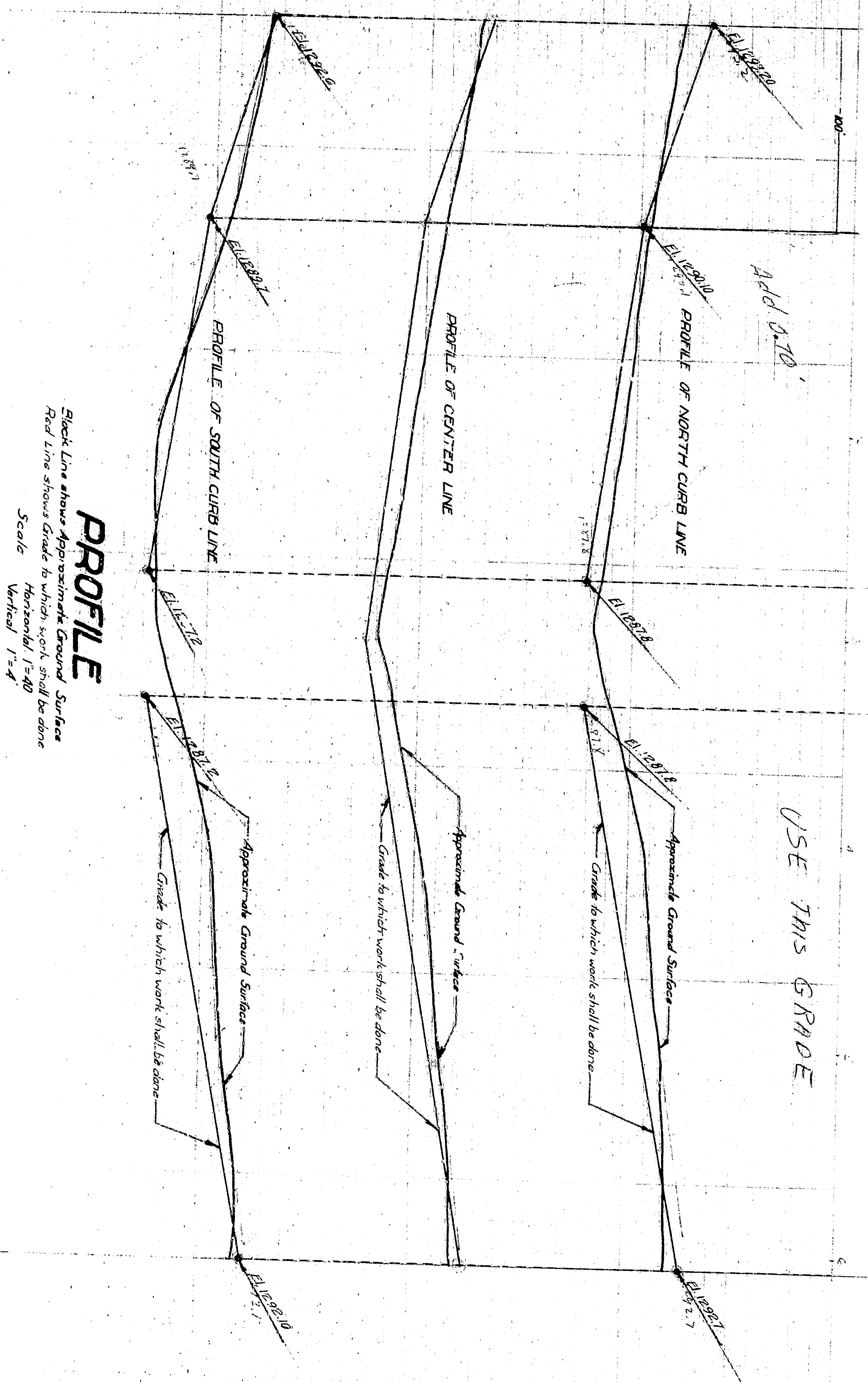
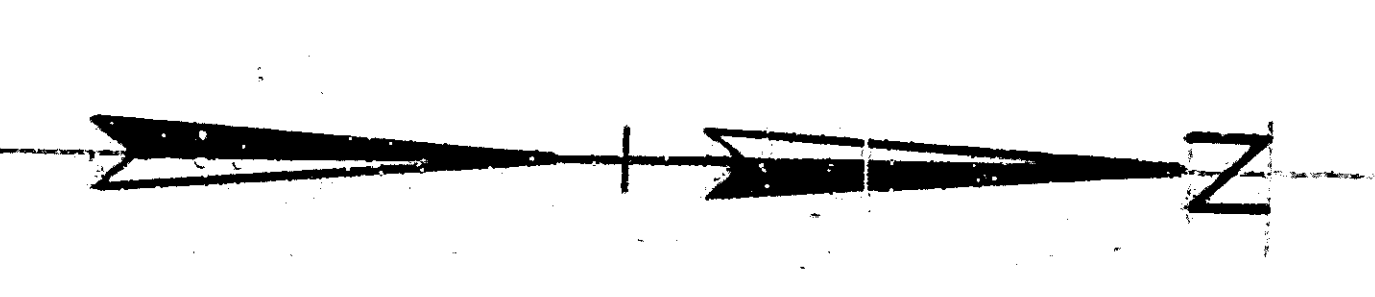

**PROFILE**

Black Line shows Approximate Ground Surface  
Red Line shows Grade to which work shall be done  
Scale  
Horizontal 1"=40'  
Vertical 1"=4'

USE THIS GRADE

**NOTE:** Legend on Sheet No. 1, Genevieve Street  
Curb Station on Sheet No. 1, 39<sup>TH</sup> Street  
Plan of Station on Sheet No. 3, 39<sup>TH</sup> Street  
Stationing on Sheet No. 3, 39<sup>TH</sup> Street  
Sections of Bureau of Highway 44 and B.B. No. 1  
Sections of Bureau of Highway 44 and B.B. No. 3

**TITLE TO STREET**  
Title of 39<sup>TH</sup> STREET by City of San Bernardino is by Dedication of the  
Sierra Way Tract as recorded in Book 39 of Maps Page 65 Records of  
San Bernardino County California.

**GRADE ORDINANCE**  
Grade of 39<sup>TH</sup> Street established January 25<sup>TH</sup> 1926 Ordinance No. 1283